

# PROGRAM

## **The First International Workshop to Promote Seismic Protective Systems for Civil Structures**

Sendai, Japan



November 21-22, 2015

Sponsored by the International Research Institute of Disaster Science  
and by the U.S. National Science Foundation



## Organizers

The PREEMPTIVE Workshop 2015 is organized by:

- Richard CHRISTENSON, *University of Connecticut*
- Kohju IKAGO, *IRIDeS and Tohoku University*
- Erik JOHNSON, *University of Southern California*
- Masayoshi NAKASHIMA, *DPRI and Kyoto University*
- Taichiro OKAZAKI, *Hokkaido University*
- Gisele RAGUSA, *University of Southern California*

The organizers gratefully acknowledge the partial support of this Workshop by:

- the *International Research Institute of Disaster Science*, Tohoku University, and
- the *U.S. National Science Foundation*, through the project "SAVI/Collaborative Research: Pacific Rim Earthquake Engineering Mitigation Protective Technologies International Virtual Environment (PREEMPTIVE)" (grants 14-46424/14-46353, Dr. Joy Pauschke, program director).



## **CONTENTS**

Workshop timetable .....	1
Venue map .....	5
Study tour map .....	7

## Workshop timetable

DAY1: Saturday 21, November		Presenters	Comments	
8:15	Bus from Hotel Bel Air Sendai to Tohoku University			
9:00	<b>Opening</b>		1F. Multi-purpose Hall	
	Welcome speech	Director of IRIDeS, Fumihiko IMAMURA	Chairs: Kohju IKAGO and Erik JOHNSON	
	Workshop overview	Richard CHRISTENSON		
9:15	<b>Case Studies Presentations</b>		1F. Multi-purpose Hall	
	Base Isolation	Scott HARVEY Hideto KANNO Akiko KISHIDA Gordon WARN	Chair: Kohju IKAGO	
	9:35	Passive Energy Dissipation		Masahiro IKENAGA Osman OZBULUT Kazutaka SHIRAI Ken WALSH
	9:55	Semi-active Damping		Maki DAN Tat FU Zhaoshuo JIANG Masayuki KOHIYAMA
10:15	<b>Breakout: Discussion of Research Needs</b>			
	Base Isolation		3F. Meeting Room – 1 Co-chairs: Akiko KISHIDA and Claudia MARIN-ARTIEDA	
	Passive Energy Dissipation		4F. Meeting Room – 2 Co-chairs: Justin MARSHALL and Kazutaka SHIRAI	
	Semi-active Damping		4F. Meeting Room – 3 Co-chairs: Masayuki KOHIYAMA and Brian PHILLIPS	
11:15	<b>Report of Breakout Discussions</b>		1F. Multi-purpose Hall	
	Base Isolation	Akiko KISHIDA Claudia MARIN-ARTIEDA	Chair: Richard CHRISTENSON	
	Passive Energy Dissipation	Justin MARSHALL Kazutaka SHIRAI		
	Semi-active Damping	Masayuki KOHIYAMA Brian PHILLIPS		
11:50	Group photo on stage		1F. Multi-purpose Hall	
12:00	Lunch		2F. Seminar Room – A	

13:00	<b>Senior lectures</b>		1F. Multi-purpose Hall Chair: Taichiro OKAZAKI
	US-Japan collaborative research, its history and future	Masayoshi NAKASHIMA	
13:30	Displacement control design concept for long-period structures	Norio INOUE	
14:00	<b>Discussion with Panel</b>		1F. Multi-purpose Hall Chairs: Richard CHRISTENSON and Taichiro OKAZAKI
	Ian BUCKLE, Norio INOUE, Masayoshi NAKASHIMA, Masato MOTOSAKA, and James RICLES		
15:00	Coffee break		1F. Foyer
15:30	<b>Breakout: Opportunities for Collaboration</b>		
	Session 1 Co-chairs: Masahiro IKENAGA Steve WOJTKIEWICZ		3F. Meeting Room – 1
	Session 2 Co-chairs: Yoshikazu ARAKI Lauren LINDERMAN		4F. Meeting Room – 2
	Session 3 Co-chairs: Yoichi MUKAI Naru NAKATA		4F. Meeting Room – 3
16:30	<b>Report of Breakout Discussions</b>		1F. Multi-purpose Hall Chair: Richard CHRISTENSON
	Session 1	Masahiro IKENAGA Steve WOJTKIEWICZ	
	Session 2	Yoshikazu ARAKI Lauren LINDERMAN	
	Session 3	Yoichi MUKAI Naru NAKATA	
17:00	Wrap-Up and Discuss Action Items		1F. Multi-purpose Hall Chairs: Kohju IKAGO and Erik JOHNSON
17:30	Dinner Reception		2F. Seminar Room – A
20:00	Adjourn		
20:15	Bus to Hotel Bel Air Sendai and Sendai station		

<b>DAY2: Sunday 22, November</b>		<b>Comments</b>
8:15	Meet in the lobby of Hotel Bel Air Sendai	
8:15 – 8:30	Walk from the hotel to NTT Aoba-dori building	
8:30 – 9:30	Visit to NTT Aoba-dori building  NTT Aoba-dori Building      Tuned Viscous Mass Damper	
9:30 – 9:45	Transportation by bus	
10:00 – 11:00	Visit to Aobayama Campus at Tohoku University  Department of Civil Engineering (Base-isolated building)	
11:00 – 11:25	Transportation by bus	Drive along tsunami affected coast
11:25 – 12:10	Lunch	
12:10 – 13:50	Transportation by bus	Drive along tsunami affected coast
13:50 – 14:30	Hiyoriyama Park 	Panoramic view of tsunami-hit Ishinomaki city

14:30 – 15:45	Transportation by bus	
15:45 – 16:10	<p>Visit to a structural remain of the disaster management center building in Minami-Sanriku</p> 	
16:10 – 19:00	Transportation by bus	
19:00	Arrive back at Sendai Station and adjourn Workshop	

# Venue Map

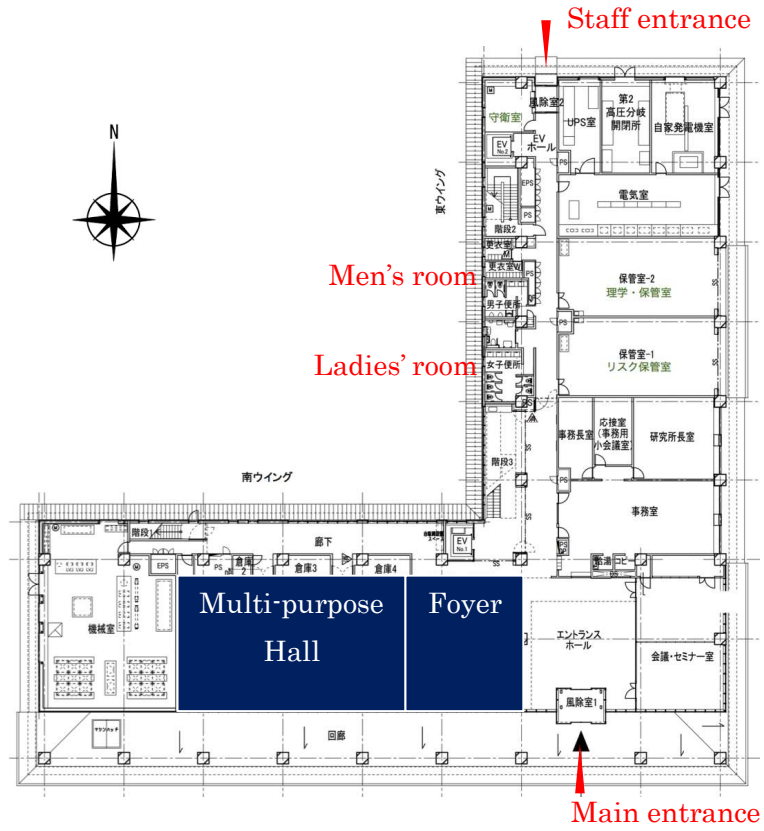

First floor

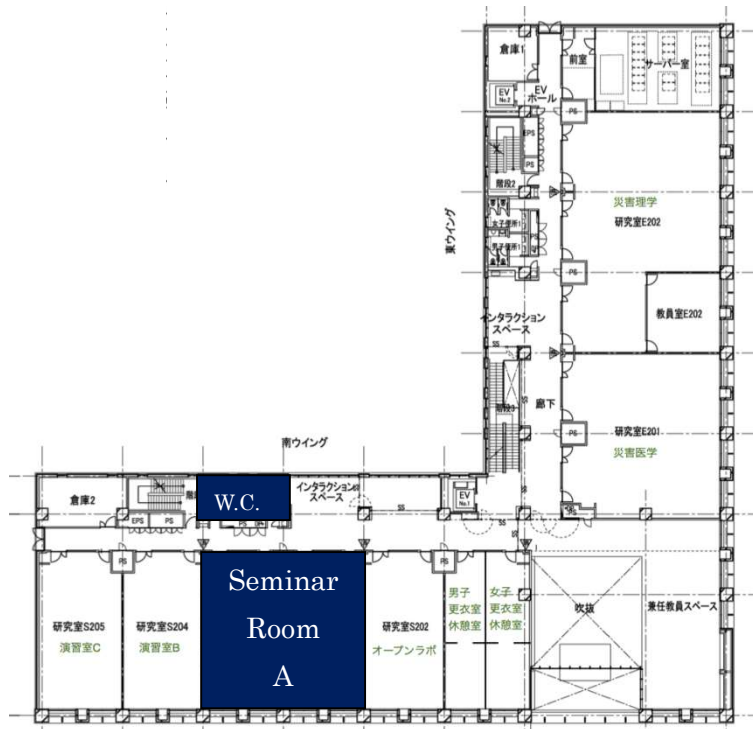

Second floor



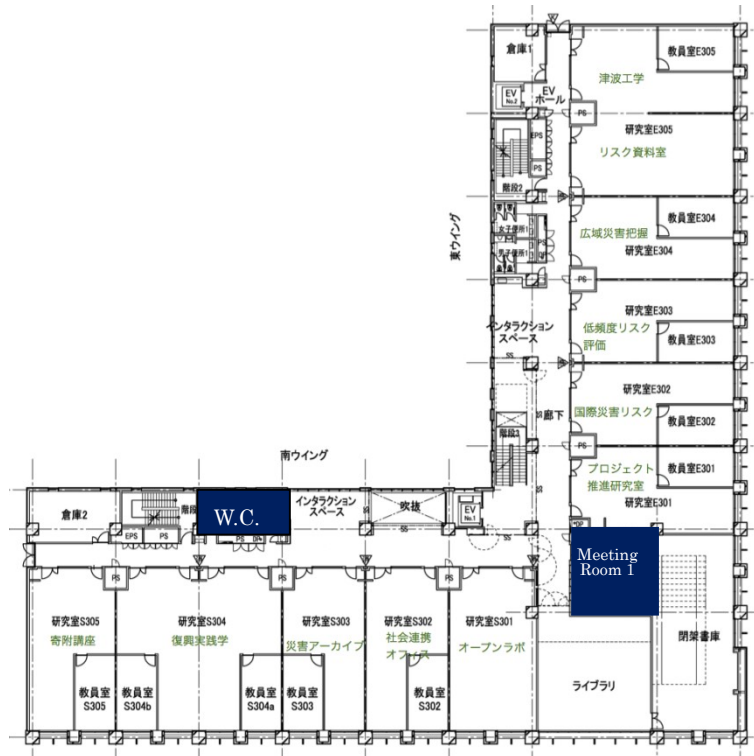

Third floor



Fourth floor

# Study tour map

